

APPLICATION 1

For office use only	File #	014-20117
	Submitted	Dec 18 2017
	Date Application considered complete	Jan 9 2018

MUNICIPALITY OF MUN. OF SOUTH HURON (EXETER)  
Application for Official Plan and/or Zoning By-law Amendment

**A. THE AMENDMENT**

1. TYPE OF AMENDMENT?

\_\_\_\_\_ Official Plan [ ] Zoning By-law No. 13-84 [ ] Both [ ]

a) Name of Official Plan to be amended: \_\_\_\_\_

b) Name of Zoning By-law to be amended: USBORNE WARD

2. WHAT IS THE PURPOSE OF AND REASONS FOR THE PROPOSED AMENDMENT(S)?

SEVERANCE PARCELS TO MATCH  
MERGING LOCATION.

**B. GENERAL INFORMATION**

3. APPLICANT INFORMATION

a) Registered Owner's Name(s): 2514421 ONTARIO INC.

Address: 70704 LONDON RD. S. EXETER 40 H.M.P.

Phone: Home ( ) \_\_\_\_\_ Work ( ) \_\_\_\_\_

Email ( ) \_\_\_\_\_ Cell ( ) \_\_\_\_\_

b) Applicant (Agent) Name(s): JASON BROWN

Address: 40 1165 THAMES RD. E, EXETER N0M 1S3 40 NORTHLANDER

Phone: Home ( ) \_\_\_\_\_ Work ( ) \_\_\_\_\_ Fax ( ) \_\_\_\_\_

Email ( ) \_\_\_\_\_ Cell ( ) \_\_\_\_\_

c) Name, Address, Phone of all persons having any mortgage, charge or encumbrance on the property:

d) Send Correspondence To? Owner [X] Agent [X] Other [ ] \_\_\_\_\_

## 4. WHAT AREA DOES THE AMENDMENT COVER?

- a) ☐ the "entire" property or  
 b) ☒ just a "portion" of the property

## 5. PROVIDE A DESCRIPTION OF THE ENTIRE PROPERTY:

Municipal Ward: USBORNE911 Address and Road Name: SEE ATTACHED PARCEL IDENTIFICATION SHEET

Roll Number (if available): \_\_\_\_\_

Concession: 1 Lot: 14 Registered Plan No.: 22R

Area: SEE APPLICATION KEY PLAN hectares Depth: \_\_\_\_\_ metres Frontage (Width): NA metres  
SEE AGM REF. PLAN ATTACHED

6. IS ANY OF THE LAND IN WELLHEAD PROTECTION AREA C? Yes ☐ No ☒ Unknown ☐

If Yes, please obtain a Restricted Land Use Permit from the Risk Management Official.

If Unknown, please consult with your Municipal Planner and obtain a Restricted Land Use Permit if necessary.

## 7. PROVIDE A DESCRIPTION OF THE AREA TO BE AMENDED IF ONLY A 'PORTION' OF THE PROPERTY:

Area: \_\_\_\_\_ hectares Depth: \_\_\_\_\_ metres Frontage (Width): \_\_\_\_\_ metres

REFER TO ATTACHED SCHEDULES: REFERENCE PLAN AND APPLICATION KEY PLAN

## 8. WHAT IS THE CURRENT PLANNING STATUS?

Official Plan Designation: HC FRONTING LONDON ROAD & RES. TO EASTZoning: R4 + D

## 9. LIST LAND USES THAT ARE PERMITTED BY CURRENT OFFICIAL PLAN DESIGNATION:

RESIDENTIAL, Commercial**C. EXISTING AND PROPOSED LAND USES AND BUILDINGS**

## 10. WHAT IS THE "EXISTING" USE OF THE LAND?

MOBILE HOME AND VACANT AGRICULTURALHow long have the existing uses continued on the subject land: 1960

## 11. WHAT IS THE "PROPOSED" USE OF THE LAND?

HC, Auto DEALERSHIP, (Future RESIDENTIAL ON retained PARCEL)

**PROVIDE THE FOLLOWING DETAILS FOR ALL BUILDINGS: (Use a separate page if necessary)**

Are any buildings proposed to be built on the subject land:

Yes [ ]

No [☒]

	<u>Existing</u>	<u>Proposed</u>
a) Type of Building(s)	_____	_____
b) Main Building Height	_____ (m)	_____ (m)
c) % Lot Coverage	_____	_____
d) # of Parking Spaces	_____	_____
e) # of Loading Spaces	_____	_____
f) Number of Floors	_____	_____
g) Total Floor Area	_____ (sq. m)	_____ sq. m)
h) Ground Floor Area (exclude basement)	_____	_____
i) Building Dimensions	_____	_____
j) Date of Construction	_____	_____
k) Setback from Buildings to:		
	Front of Lot Line	_____
	Rear of Lot Line	_____
	Side of Lot Line	_____

**D. EXISTING AND PROPOSED SERVICES****12. INDICATE THE APPLICABLE WATER SUPPLY AND SEWAGE DISPOSAL:**

	<u>Municipal Water</u>	<u>Communal Water</u>	<u>Private Well</u>	<u>Municipal Sewers</u>	<u>Communal Sewers</u>	<u>Private Septic</u>
a) Existing	[ <input checked="" type="checkbox"/> ]	[ ]	[ ]	[ ]	[ ]	[ <input checked="" type="checkbox"/> ] <i>ON RETAINED LANDS</i>
b) Proposed	[ ]	[ ]	[ ]	[ ]	[ ]	[ ]
c)	If the requested amendment would permit development on a privately owned and operated individual or communal septic system and more than 4500 litres of effluent would be produced per day as a result of the development being completed, the applicant must submit:					
	[ ]	a servicing options report; and				
	[ ]	a hydrogeological report.				

13. Will storm drainage be provided by:

Sewers	[ <input checked="" type="checkbox"/> ]
Ditches	[ ]
Swales	[ ]
Other	[ ] Specify _____

Is storm drainage present or will it be constructed N.A.

**14. TYPE OF ACCESS (CHECK APPROPRIATE SPACE)**

- ☒ provincial highway *(ALL WITHIN CONNECTING LINK)*
- ☐ county roads
- ☐ municipal roads, maintained all year
- ☐ municipal road, seasonally maintained
- ☐ right of way
- ☐ water access

**E. OFFICIAL PLAN AMENDMENT**

(Proceed to Section F) if an Official Plan Amendment is not proposed).

**15. DOES THE PROPOSED OFFICIAL PLAN AMENDMENT DO THE FOLLOWING?**

Add a Land Use designation in the Official Plan	Yes [ ]	No [ ]	Unknown [ ]
Change a Land Use designation in the Official Plan	Yes [ ]	No [ ]	Unknown [ ]
Change a policy in the Official Plan	Yes [ ]	No [ ]	Unknown [ ]
Replace a policy in the Official Plan	Yes [ ]	No [ ]	Unknown [ ]
Delete a policy in the Official Plan	Yes [ ]	No [ ]	Unknown [ ]
Add a policy in the Official Plan	Yes [ ]	No [ ]	Unknown [ ]

**16. IF APPLICABLE AND KNOWN AT TIME OF APPLICATION, PROVIDE THE FOLLOWING:**

- a) Section Number(s) of Policy to be Changed \_\_\_\_\_
- b) Text of the proposed new policy attached on a separate page? Yes [ ] No [ ]
- c) New designation name: \_\_\_\_\_
- d) Map of proposed new Schedule attached on a separate page? Yes [ ] No [ ]

**17. LIST PURPOSE OF AMENDMENT AND LAND USES THAT WOULD BE PERMITTED BY THE PROPOSED AMENDMENT:**

\_\_\_\_\_

**18. Does the requested amendment alter all or any part of the boundary of an area of settlement in a municipality or establish a new area of settlement in a municipality?**

Yes [ ] No [ ]

If yes: Attach the current official plan policies, if any, dealing with the alteration or establishment of an area of settlement.

**19. Does the requested amendment remove the subject land from any area of employment?**

Yes [ ] No [ ]

If yes: Attach the current official plan policies, if any, dealing with the removal of land from an area of employment.

**20. Is the requested amendment consistent with the Provincial Policy Statement issued under Section 3 (1) of the Planning Act.**

Yes [ ] No [ ] Unknown [ ]

**F. ZONING BY-LAW AMENDMENT**

(Proceed to Question 29 (Drawing) if a Zoning By-law Amendment is not proposed).

**21. DOES THE PROPOSED ZONING BY-LAW AMENDMENT DO THE FOLLOWING?**

Add or change zoning designation in the Zoning By-law	Yes <input checked="" type="checkbox"/>	No <input type="checkbox"/>	Unknown <input type="checkbox"/>
Change a zoning provision in the Zoning By-law	Yes <input checked="" type="checkbox"/>	No <input type="checkbox"/>	Unknown <input type="checkbox"/>
Replace a zoning provision in the Zoning By-law	Yes <input type="checkbox"/>	No <input checked="" type="checkbox"/>	Unknown <input type="checkbox"/>
Delete a zoning provision in the Zoning By-law	Yes <input type="checkbox"/>	No <input checked="" type="checkbox"/>	Unknown <input type="checkbox"/>
Add a zoning provision in the Zoning By-law	Yes <input type="checkbox"/>	No <input checked="" type="checkbox"/>	Unknown <input type="checkbox"/>

**22. IF APPLICABLE AND KNOWN AT TIME OF ZONING APPLICATION, PROVIDE THE FOLLOWING:**

- a) Section Number(s) of provisions to be changed
- b) Text of the proposed new provision attached on a separate page? Yes ☐ No ☐
- c) New zone name: SEE ATTACHED KEY PLAN SCHEDULE
- d) Map of proposed new Key Map attached on a separate page? Yes ☒ No ☐

**23. LIST LAND USES PROPOSED BY ZONING AMENDMENT.**CAR DEALERSHIP- date the current owner acquired the subject land 2015**24. HAS THERE BEEN A PREVIOUS APPLICATION FOR REZONING UNDER SECTION 34 OF THE PLANNING ACT AFFECTING THE SUBJECT PROPERTY:**Yes ☐ No ☒**25. Is the intent of this application to implement an alteration to the boundary of an area of settlement or to implement a new area of settlement?**Yes ☐ No ☒

If yes: Attach details of the official plan or official plan amendment that deals with the matter.

**26. Is the intent of this application to remove land from an area of employment?**Yes ☐ No ☒

If yes: Attach details of the official plan or official plan amendment that deals with the matter.

**27. Is the application for an amendment to the zoning by-law consistent with provincial policy statement issued under Section 3 (1) of the Planning Act.**Yes ☒ No ☐ Unknown ☐

**G. SKETCH CHECKLIST**

28. **ACCURATE, TO SCALE, DRAWING OR PROPOSAL:** (In the space below or on a separate page(s), please provide drawing of the proposal, preferably prepared by a qualified professional. In some cases, it may be more appropriate to prepare additional drawings at varying scales to better illustrate the proposal).

The application shall be accompanied by a clean, legible sketch sharing the following information. Failure to supply this information will result in a delay in processing the application.

A sketch showing in metric units:

- a) the boundaries and dimensions of the subject land;
- b) the location, size and type of all existing and proposed buildings and structures on the subject land, indicating their distance from the front lot line, rear lot line and side lot lines;
- c) the approximate location of all natural and artificial features (for example, buildings, railways, roads, watercourses, drainage ditches, banks of rivers or streams, wetlands, wooded areas, wells and septic tanks) that,
  - i) are located on the subject land and on land that is adjacent to it, and
  - ii) in the applicant's opinion may affect the application;
- d) the current uses of land that is adjacent to the subject land;
- e) the location, width and name of any roads within or abutting the subject land, indicating whether it is an unopened road allowance, a public traveled road, a private road or a right of way;
- f) if access to the subject land will be by water only, the location of the parking and docking facilities to be used;
- g) the location and nature of any easement affecting the subject land

The drawing(s) should show (please use a survey if available):

- Property boundaries and dimensions
- Dimensions of area of amendment
- Distance from structures to lot lines
- Easements or restrictive covenants
- Building dimensions & location
- Neighbouring adjacent land uses
- Parking and loading areas
- Use of Neighbouring properties
- Public roads, allowances, rights of way
- Municipal Drains/Award Drains
- Wetlands, floodplain, wet areas
- Woodlots, forested areas, ANSI's, ESA's
- Driveways and lanes
- Other features (bridges, wells, railways, septic systems, springs, slopes, gravel pits)
- Natural watercourses
- North arrow

**H. OTHER RELATED PLANNING APPLICATIONS**

29. **HAS THE APPLICANT OR OWNER MADE APPLICATION FOR ANY OF THE FOLLOWING, EITHER ON OR WITHIN 120 METRES OF THE SUBJECT LAND?**

Official Plan Amendment	Yes [ ]	No [ ]
Zoning By-law Amendment	Yes [ ]	No [ ]
Minor Variance	Yes [ ]	No [ ]
Plan of Subdivision	Yes [ ]	No [ ]
Consent (Severance)	Yes [✓]	No [ ]
Site Plan Control	Yes [ ]	No [ ]

## 30. IF THE ANSWER TO QUESTION 29 (above) IS YES, PLEASE PROVIDE THE FOLLOWING INFORMATION:

File No. of Application:	B15/17, B16/17, B17/17, B18/17	D1409-15
Approval Authority:	COUNTY MURON	M.O.S.H.
Lands Subject to Application:	SUBJECT PROPERTY	70732 London R.O.S.
Purpose of Application:	MINOR BOUNDARY ADJUSTMENTS	RE-ZONE TO CARLOT
Status of Application:	APPROVED SEPT/17	APPROVED
Effect on the Current Application for Amendment:	CONDITION OF CONSENTS.	

**I. OTHER SUPPORTING INFORMATION**

## 32. PLEASE LIST THE TITLES OF ANY SUPPORTING OR ATTACHED DOCUMENTS:

(e.g. Environmental Impacts Study, Hydrogeological Report, Traffic Study, Market Area Study, Aggregate License Report, Stormwater Management Report etc. It is recognized that the applicant meet with planning staff to attempt to determine the supporting documents that will be required).

REFER TO ATTACHED SCHEDULES:  
 PARCEL IDENTIFICATION SHEET  
 APPLICATION KEY PLAN I  
 AGM R-PLAN FILE # L-4685-2

**J. PUBLIC CONSULTATION STRATEGY**

## 33. PLEASE OUTLINE YOUR PROPOSED STRATEGY FOR CONSULTING WITH THE PUBLIC WITH RESPECT TO THIS AMENDMENT REQUEST:

(e.g. individual contact, hold a neighbourhood meeting, telephone conversation, letter explaining proposal & inviting questions/comments, website/internet, etc.).

ON-SITE SIGN POSTING SIMILAR TO CONSENT NOTICE

**K. AUTHORIZATION FOR AGENT/SOLICITOR TO ACT FOR OWNER:**(If affidavit (K) is signed by an Agent/Solicitor on Owner's behalf, the Owner's written authorization below must be completed).I (we) WAYNE HAMATHIER of the MUN. of SOUTH HURON County/Regionof HURON do hereby authorize JASON BROWN to act as my agent in the application.Wayne Hamathier  
Signature of Owner(s)Dec/15/2017  
Date**L. APPLICANT'S DECLARATION**(This must be completed by the Person Filing the Application for the proposed development site.)I, JASON BROWN of the CITY OF LONDON,  
(Name of Applicant) (Name of Town, Township, etc.)In the Region/County/District MIDDLESEX solemnly declare that all of the statements contained in this application and supporting documentation are true and complete, and I make this solemn declaration conscientiously believing it to be true, and knowing that it is of the same force and effect as if made under oath, and by virtue of the "Canada Evidence Act."

Please be advised the responsibility for filing a complete application rests solely with the owner/applicant. Anything not requested or applied for in this application and subsequently found to be necessary (which may require another application(s) and fee(s)) are the sole responsibility of the owner/applicant. The County/Municipality will address only the application as applied for, and any items that are not included in the application are not the responsibility of the County/Municipality.

All studies required to support this application shall be at the expense of the applicant and included at the time of submission as a complete application. Where the County/Municipality incurs costs for the peer review of any consultants' reports or fees for legal opinions, the County/Municipality will be reimbursed such costs by the applicant.

In the event of third-party appeals to applications approved by the County/Municipality, the applicant may be responsible for some or all of the legal and other costs incurred by the County/Municipality, at the discretion of the County/Municipality.

DECLARED before me at:  
Region/County/Districtof Huron

In the Municipality of

South Huron[Signature]  
SignatureThis 20 day of December, 2017  
(Day) (Month) (Year)

Signature

JASON BROWN  
Please Print name of ApplicantR. Lallochi  
Commissioner of OathsSWORN BEFORE ME AT THE Municipality of  
South Huron, in the County of Huron and the  
Province of Ontario,  
this 20 day of December, 2017  
R. Lallochi  
Rebekah Meuya-Collison, Deputy Clerk  
Municipality of South Huron  
A COMMISSIONER ETC.



**M. OWNER/APPLICANT'S CONSENT DECLARATION**

In accordance with the provisions of the Planning Act, it is the policy of the County Planning Department to provide the public access to all development applications and supporting documentation.

In submitting this development application and supporting documentation, I JASON BROWN the ~~owner~~ the authorized applicant, hereby acknowledge the above-noted policy and provide my consent, in accordance with the provisions of the Municipal Freedom of Information and Protection of Privacy Act, that the information on this application and any supporting documentation provided by myself, my agents, consultants and solicitors, will be part of the public record and will also be available to the general public.

I hereby authorize the County of Huron staff, Municipal staff and council members of the decision making authority to access to the subject site for purposes of evaluation of the subject application.

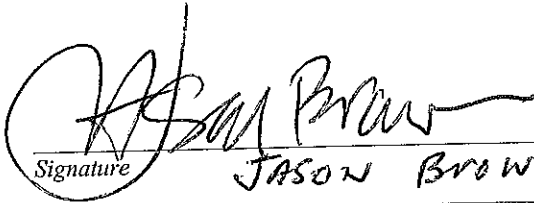
  
Signature JASON BROWN

DEC 15 / 2017  
Date

APPLICATION AND FEE OF \$ 1,836 - RECEIVED BY THE MUNICIPALITY

  
Signature of Commissioner

DEC 20 / 17  
Date

**COMPLETE THIS FORM TO DETERMINE IF  
HEALTH UNIT COMMENTS ARE REQUIRED  
ON YOUR PLANNING APPLICATION**

~~For certain planning applications, comments are required from the Huron County Health Unit to assist the municipality in its decision on your application. This sheet will determine if comments are required from the Health Unit, and if some, the appropriate fee\* must be submitted with your application and paid to the municipality (\*based on the Health Unit's User Fee Schedule).~~

~~Name of Applicant: \_\_\_\_\_~~

~~Name of Owner (if different from the applicant): \_\_\_\_\_~~

~~Location of Property (Lot, Concession or Registered Plan, and Municipality): \_\_\_\_\_~~

Type of Planning Application(s) submitted with this form:

- |  |  |
|--|--|
| <input type="checkbox"/> Consent (severance)     | <input type="checkbox"/> Minor Variance                  |
| <input type="checkbox"/> Zoning By-Law Amendment | <input type="checkbox"/> Plan of Subdivision/Condominium |
| <input type="checkbox"/> Official Plan Amendment |  |

Please answer **Section A** OR **Section B**, depending on the type of servicing available. In the following question, "property" means the subject property or, in the case of a severance, each of the resulting lots.

**Section A** - Where **SANATARY SEWERS** are available.

Is the property within 183 metres (600 feet) of an abattoir (slaughter house)?	<input type="checkbox"/> Yes	<input type="checkbox"/> No
--	------------------------------	-----------------------------

**Section B** - Where **SEPTIC SYSTEMS** are required.

The application is for the creation of a new lot for which the primary use will be a new dwelling (other than a new dwelling on a farm).	<input type="checkbox"/> Yes	<input type="checkbox"/> No
Is the property less than .4 hectares (1 acre) in area?	<input type="checkbox"/> Yes	<input type="checkbox"/> No
Does the property have less than .2 hectares (1/2 acre) of "useable land" for a septic tank and tile bed? See definition of "useable land" below.	<input type="checkbox"/> Yes	<input type="checkbox"/> No
I am uncertain of the location of the existing septic tank and tile bed on the property.	<input type="checkbox"/> Yes	<input type="checkbox"/> No
There will be more than one dwelling unit on each lot.	<input type="checkbox"/> Yes	<input type="checkbox"/> No
An industrial or commercial use is proposed which will require a septic system.	<input type="checkbox"/> Yes	<input type="checkbox"/> No
Is the property with 183 metres (600 feet) of an abattoir (slaughter house)?	<input type="checkbox"/> Yes	<input type="checkbox"/> No
The application is for a new Plan of Subdivision/Condominium	<input type="checkbox"/> Yes	<input type="checkbox"/> No
Proceed to <b>Section C</b> .		

"Useable Land" means an area of land with suitable original soil for the installation of a Class 4 subsurface sewage disposal system, free of any buildings, structures swimming pools, etc. and such land is or will be used solely for a septic tank and tie bed and any future replacement of the tile bed; and which area is at least 3 metres (10 feet) from any property line, at least 15 metres (15 feet) from a top-of-bank of a watercourse or lake, not located in a flood plain, not located in an environmentally sensitive area, and does not contain field tile or other artificial drainage. (other restrictions may apply according to legislation.)

**Section C - HEALTH UNIT FEES**

If the answer to any question in Section A or B is "Yes", then Health Unit comments will be required and the appropriate fee must be submitted with your application, as follows:

Type of Application	Health Unit Fee (To be added to the application fee)	Any required Health Unit fee should be added to the application fee and submitted in one payment to the municipality. Where two applications are being processed together (such as a severance and a rezoning) only one fee will apply, being the higher of the two fees.
Official Plan Amendment	\$177.25	
Rezoning	\$124.75	
Minor Variance	\$124.75	
Severance resulting in 2 lots or fewer	\$262.65	
Severance resulting in 3 lots or more	\$499.00	
Plan of Subdivision/Condominium	\$1037.45	

**Note:** Regardless of the results from Section A or B, some applications may require comments from the Health Unit as identified through the planning process. In these cases, the relevant fee shall apply.

\_\_\_\_\_  
Name of Owner or Designated Agent

\_\_\_\_\_  
Signature and Date

To be completed by Municipal Clerk: Has the Health Unit Fee been collected from the applicant?

☐ Yes

☐ No

Amount: \_\_\_\_\_

\_\_\_\_\_  
Name of Clerk-Treasurer

SCHEDULE "A"  
**KEY MAP 5A**  
TOWNSHIP OF USBORNE

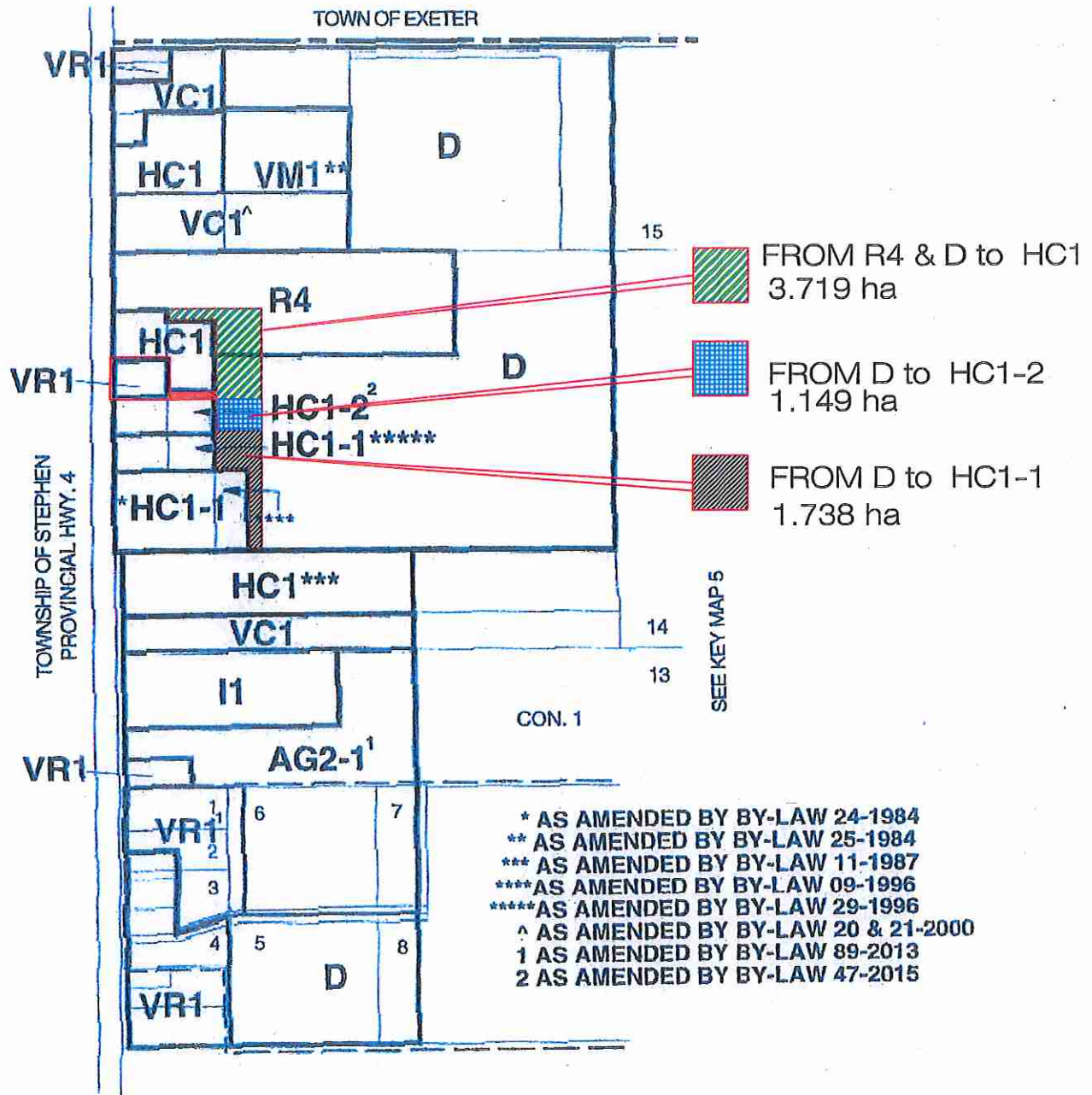
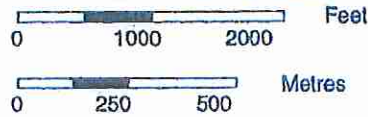

# ReZoning Application 1

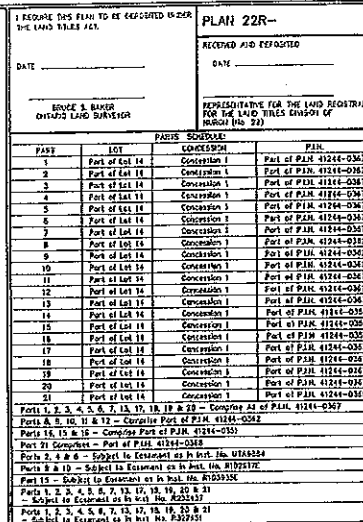
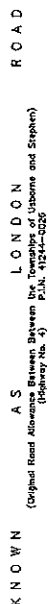

PLAN OF SURVEY  
OF PART OF  
LOT 14, CONCESSION 1  
(Geographic Township of Uxborne)  
IN THE  
MUNICIPALITY OF SOUTH HURON  
COUNTY OF HURON

SCALE 1:750

SCALE IN METERS

2015  
ARCHIBALD, GRAY & MCKAY LTD.  
ONTARIO LAND SURVEYORS

NOTES AND LEGEND:

BEARINGS ARE UTM GRID IN HANDS (CHRS) DERIVED FROM GPS OBSERVATIONS AND THE CAVI-MET BASE STATION NETWORK AND ARE SECURED TO THE CENTRAL MERIDIAN EIGHT WEST LONGITUDE ZONE 12

POINT ID	NORTHING	EASTING
UTM A	478667.781	461176.248
UTM B	478632.118	461356.424
UTM C	478637.874	461728.593

LINEAR VALUES SHOWN ON THIS PLAN ARE GROUND LEVEL DISTANCES AND CAN BE CONVERTED TO GRID DISTANCES BY MULTIPLYING BY A CORRECTION SCALE FACTOR OF 0.999817401.

[illegible]

**ROTATION NOTE**

METRIC: DISTANCES AND COORDINATES SHOWN ON THIS PLAN ARE IN METRES  
SEE BY OTHERS P.L. 1048

SURVEYOR'S CERTIFICATE

I CERTIFY THAT:

1) THIS SURVEY AND PLAN ARE CORRECT AND IN ACCORDANCE WITH THE SURVEYS ACT, THE SURVEYORS ACT AND THE LAND TITLES ACT AND THE REGULATIONS MADE UNDER THEM

2) THE SURVEY WAS COMPLETED ON THE 3 DAY OF 8, 2012.

LONDON, ENGLAND

BRUCE S. BAYER  
CHITRAO LAND SURVEYOR



**ARCHIBALD, GRAY & McKAY LTD.**  
9514 WHITE OAK ROAD, LONDON, ON, M6E 2Z5  
PHONE: 518-646-8300 FAX: 518-646-4300  
E-MAIL: info@agm.ca Web: www.agm.ca

PLAN • SURVEY • ENGINEER		DATE: 11/11/2011	TIME: 11:41 AM
DRAWN BY: HORTON	DORTAL FILE: 051501PPEC.dwg	PLAN No:	
CHECKED BY: D.D.C.	ECG FILE: 051501PPEC.dwg	1-4885-7	

E:\FRAN\100-468791\US-01\VS-01-14\VS-01-14-11\CADWSTMOIS.PIC d-



BEAN office/hospice  
588 MAIN ST. S

part 14  
as in R  
Usborne  
Inst. No

772.22'

1,660.78'

70760A LONDON RD.  
NORWOOD VILLAGE  
2016 purchase by Hamather Group  
2514421 Ontario Inc.

part lot 14, Con 1,  
Usborne Twp. Part 6 to 15  
RD66, (pin 41244-0362(LT))  
S/T R102120, R102131E  
Mun of South Huron

part lot 14, Con 1,  
Usborne Twp.  
(pin 41244-0363  
Mun of South Huron

part lot 14, Con 1, Usborne Twp.  
As in R339515± S/T R104110E  
Mun of South Huron

Mobile Home

storage shed

FROM R4 & D to HC1  
3.719 ha

70740 LONDON RD.

HAMATHER MOTOR products Ltd.

R4 ZONE LINE

'D' ZONE LINE

house raised  
HAMATHER MOTOR  
Products Ltd.

70736 LONDON RD.

4.93m width merges  
with 70740

FROM VR1 to HC1

1.951 ha

former HENDRICK

2422579 Ontario Inc.

70732 LONDON RD.

329 FT

70704 LONDON RD.

HAMATHER MOTOR  
Products Ltd.

1.149 ha  
FROM D to HC1-2

70704 London Rd.

HURON MOTOR  
Products Ltd.

FROM D to HC1-1  
1.738 ha

part lot 14, Con 1, Usborne Twp.  
As in R215433 4 P1, 22R3923, S/T R3923,  
S/T R233437, R321951  
Mun of South Huron

part lot 14, Con 1, Usborne Twp.  
As in R226473,  
Mun of South Huron

70692 LONDON RD.

Hamather Motor  
Products Ltd.

70676 LONDON RD.

YET ( MEMMEL-SHAPIRO)

70676 LONDON RD.

LONDON ROAD

#4