

Kirkton Woodham Community Centre Board
Kirkton, Ontario.
N0K1K0

November 15th, 2024

The Municipality Of South Huron
Box 759
Exeter, Ontario
N0M 1S6

Dear Members of Council,

The Kirkton Woodham Community Centre Board would request that you consider for budgeting the proposed upgrades to the Community Centre.

The outdoor lighted sign is beyond repair and replacement is required in the near future. We have attached documentation gathered by the board, and other community groups, which have pledged support to that project. This includes the Kirkton Woodham Optimists and the Kirkton Agricultural Society. We would hope to see this included in the 2025 budget.

Future considerations are; new stackable chairs, and the much requested addition of a video projection system and screen for the large hall.

Thank you in advance for your consideration.

On behalf of the board,

Chris Weernink

Chris Weernink
Chairman

Ministry of Transportation

Highway Corridor Management Section - London Office
659 EXETER RD
LONDON, ON
N6E 1L3



May 10, 2024

Kirkton Woodham Optimist
70497 164 RD
KIRKTON, ON
N0K 1K0

Dear Vernon:

Re: SG-2024-31L-00000035 V1

Please find attached your Sign Permit, which has been issued in accordance with the ***PUBLIC TRANSPORTATION AND HIGHWAY IMPROVEMENT ACT, R.S.O. 1990, P50.***

It is the responsibility of the permit holder to ensure that all employed/contracted personnel performing the work are aware of and adhere to all conditions of the permit.

If you have any questions or require further assistance, please contact the undersigned.

Sincerely,

A handwritten signature in black ink, appearing to read "Joanne Moyes", written over a horizontal dashed line.

Joanne Moyes
Corridor Management Officer

659 EXETER RD
LONDON, ON
N6E 1L3

Attach.

MINISTRY OF TRANSPORTATION



**Highway Corridor Management
Sign Permit
SG-2024-31L-0000035 V1**

ISSUED TO

PROPERTY OWNER: KIRKTON WOODHAM OPTIMIST
APPLICANT/TENANT: KIRKTON WOODHAM OPTIMIST

LOCATION OF WORK

HIGHWAY: 23

STREET ADDRESS:

GPS CO-ORDINATES: Start: 43.328505, -81.310354 End: N/A

LOT/SECTION: LOT 7 **CON:** SOUTH EASTERN BOUNDARY **GEOGRAPHIC TOWNSHIP:** USBORNE **LOT/BLOCK:** N/A **PLAN NO:** N/A
MUNICIPALITY: MUNICIPALITY OF SOUTH HURON **REFERENCE PLAN PART:** N/A **REFERENCE PLAN NO:** N/A

PERMIT DETAILS

TYPE OF SIGN: Location **PURPOSE OF APPLICATION:** Alter existing sign(s)
TOTAL PERMITTED NUMBER OF SIGN(S): 2 **TOTAL PERMITTED AREA OF SIGN(S):** 9.10 m²

DISTANCE FROM HIGHWAY PROPERTY LINE TO SIGN CLOSEST TO THE HIGHWAY: 23.16 m

DESCRIPTION: To replace one existing static double sided pylon sign facing North and South, with both a static panel and LED Variable message sign panel on totaling 4.55m², as per attached information file. Transition effects such as wipe, slide, fade or pixelate are not permitted. Messages are restricted to advertising the business on site. Refer to attached Appendix 'A' for further details.

EXPIRY DATE: N/A

DATED AT: London Office

DATED ON: May 10,
2024

A handwritten signature in black ink that reads "Jodie Lucante".

Authorized Signatory

THIS PERMIT IS ISSUED UNDER THE AUTHORITY VESTED IN THE MINISTER BY THE PUBLIC TRANSPORTATION AND HIGHWAY IMPROVEMENT ACT AND THE REGULATIONS PURSUANT THERETO AND IN SUBJECT TO THE CONDITIONS ATTACHED TO THE PERMIT, INCLUDING ANY AGREEMENT APPLICABLE TO THE SIGN AUTHORIZED BY THE PERMIT

Highway Corridor Management Permit Conditions

Permit Number: SG-2024-31L-00000035

Permit Version: 1

Date Approved: May 10, 2024

The permit is subject to the following conditions:

1. In addition to the conditions of this permit, the registered property owner must meet all of the requirements of the local municipality and any other agency having jurisdiction.
2. The work for this permit must commence within 6 months of the date that the permit is issued, or the permit shall be void and cancelled by the Ministry.
3. All work authorized by this permit shall be carried out in accordance with the approved plans, specifications and agreements and subject to the approval of the Ministry. The registered property owner must bear all expenses related thereto.
4. Vegetation on the right of way must not be cut or trimmed without the written permission of the Ministry. Any cutting or trimming permitted must only be done under the supervision of the Ministry or its authorized agent at the expense of the registered property owner. Any cutting or trimming of vegetation adjacent to the highway right-of-way requires the permission of the land owner.
5. The registered property owner shall ensure that the operation of the highway is not interfered with, and that the right-of-way remains free of debris, earth or other materials.
6. If there is an expiry date on this permit and a further term is required, a request shall be made to the Ministry before the expiry date. An extension may be approved, approved with additional conditions, or denied by the Ministry.
7. If during the life of this permit any Acts are passed or regulations adopted which affect the rights herein granted, the said Acts and regulations shall be applicable to this permit from the date on which they come into force.
8. The registered property owner holds harmless the Ministry for all damages and liabilities caused as a result of the works undertaken pursuant to this permit.
9. This permit may be cancelled at any time for breach of the regulations or conditions of this permit, or for such other reasons as the Ministry at its sole discretion deems proper. When a permit is cancelled for any reason, the registered property owner shall not be entitled to any compensation or damages by reason of or arising from the cancellation of the permit.
10. If this permit expires, all works constructed, maintained or operated under this permit, if the Ministry so requests, shall be removed at no cost to the Ministry.
11. Each sign authorized by this permit shall be maintained in a condition satisfactory to the Ministry. Failure to maintain the sign(s) in a satisfactory condition shall result in the cancellation of this permit.
12. This permit is not transferable from one registered property owner to another. If the registered property changes ownership then the new registered property owner must apply for a new sign permit. Each new permit is subject to the conditions in effect at the time of applying.
13. Any future development on this site will require MTO's review and approval.

KIRKTON WOODHAM

Community Centre

Sign Cabinet - 41in H x 8ft 3in L
x 5in depth

Viewing AREA - 36in H x 8ft L

Message Sign to meet
MOT & MTT
guidelines

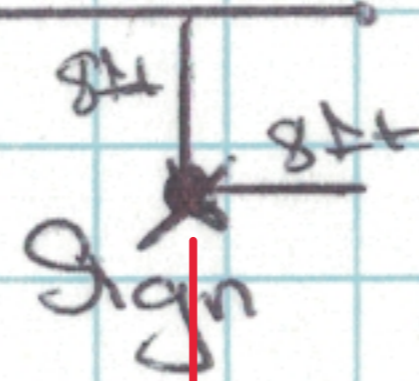
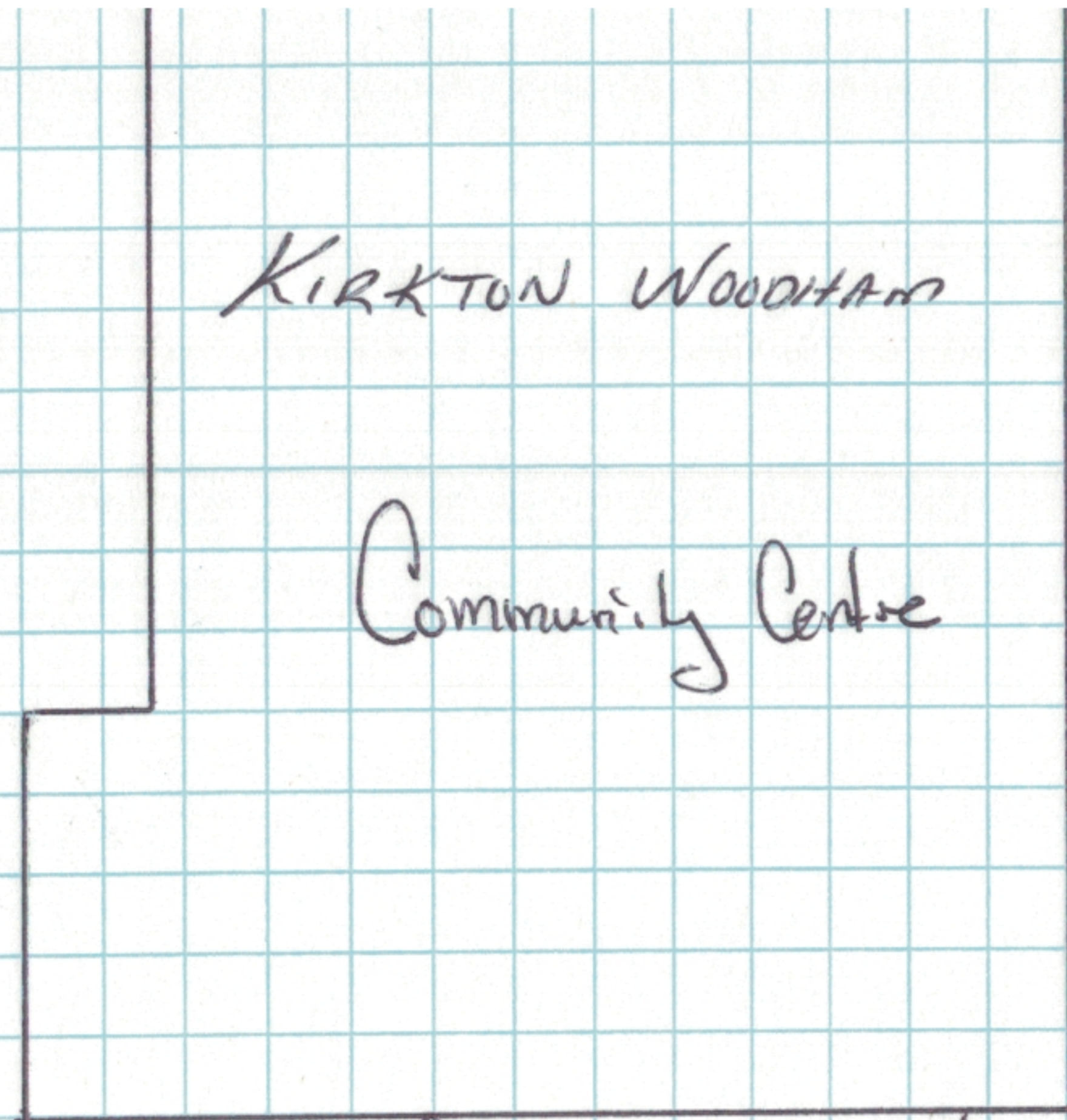

84 ft

76ft / 23.16m

Entrance

Property Line

Entrance

36ft

Hwy Shoulder

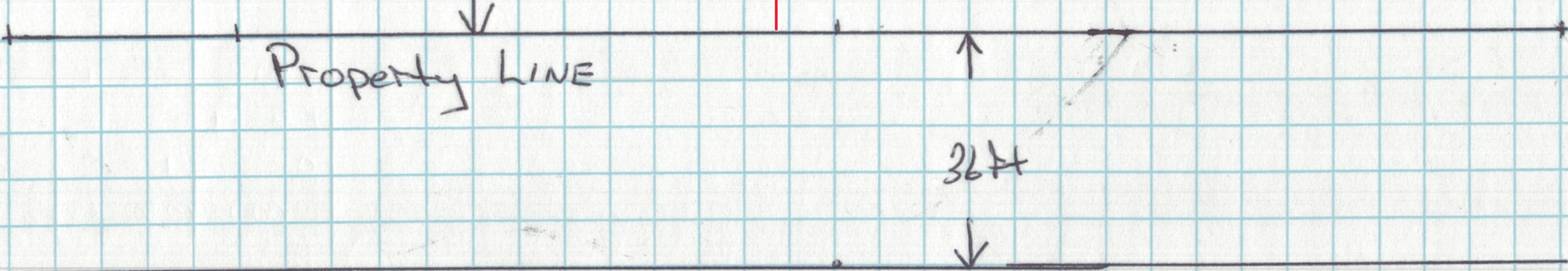

PROJECT: NEW Pylon Sign with white double high output LED Cabinet, and NEW Watchfire Video Displays.

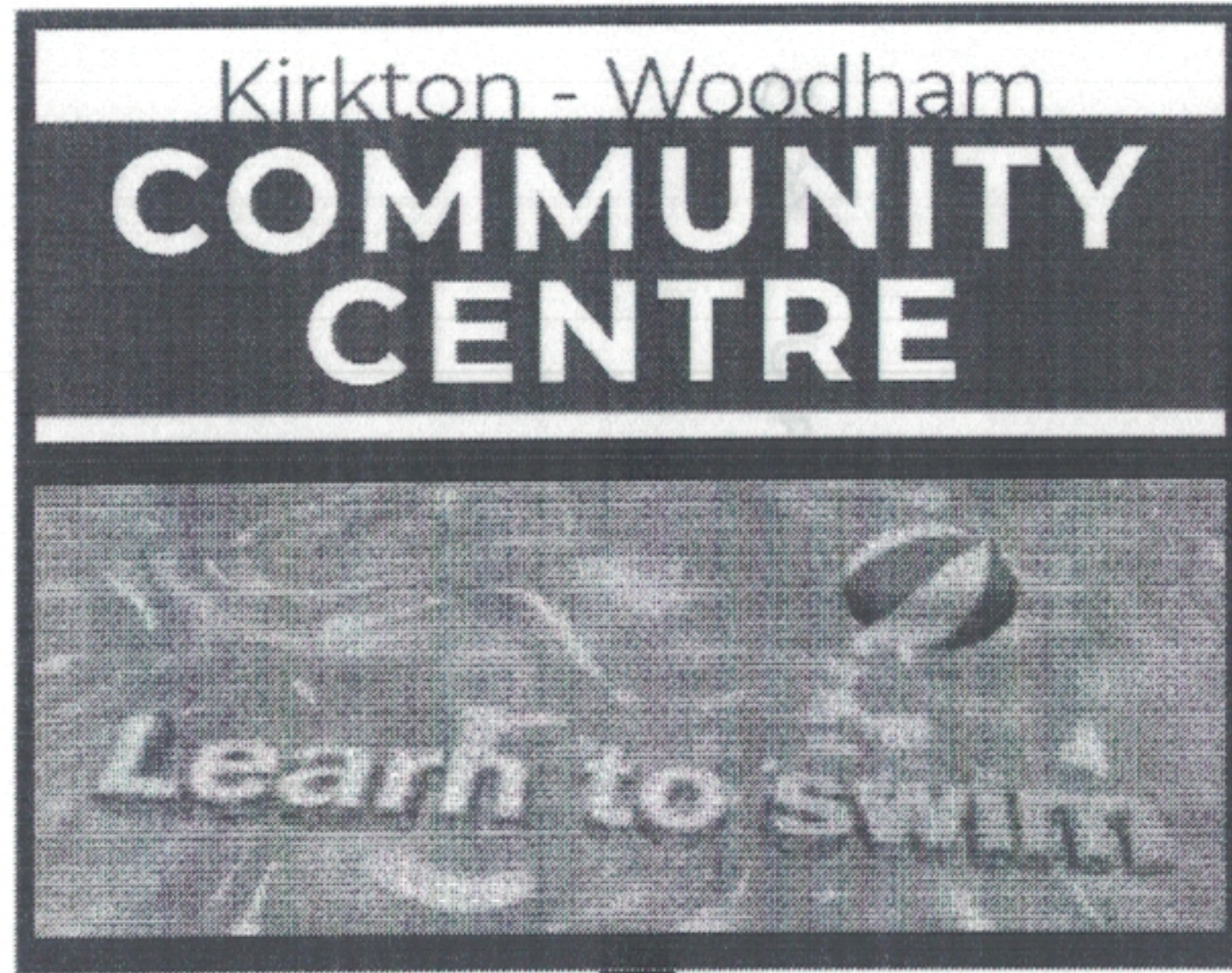

4.9m

0.941m

foot change

Proposed Pylon Sign

12 ft existing 6 in HSS Pole

Top Cabinet **99 x 36 in** 2.5m x 0.91m
Double Sided
White Polycarbonate
Translucent Vinyl Graphics

Video Displays **8 x 3 ft** 2.44m x 0.91m
W8mm LED RGB
Full Colour 30 FPS
Ignite OP Software

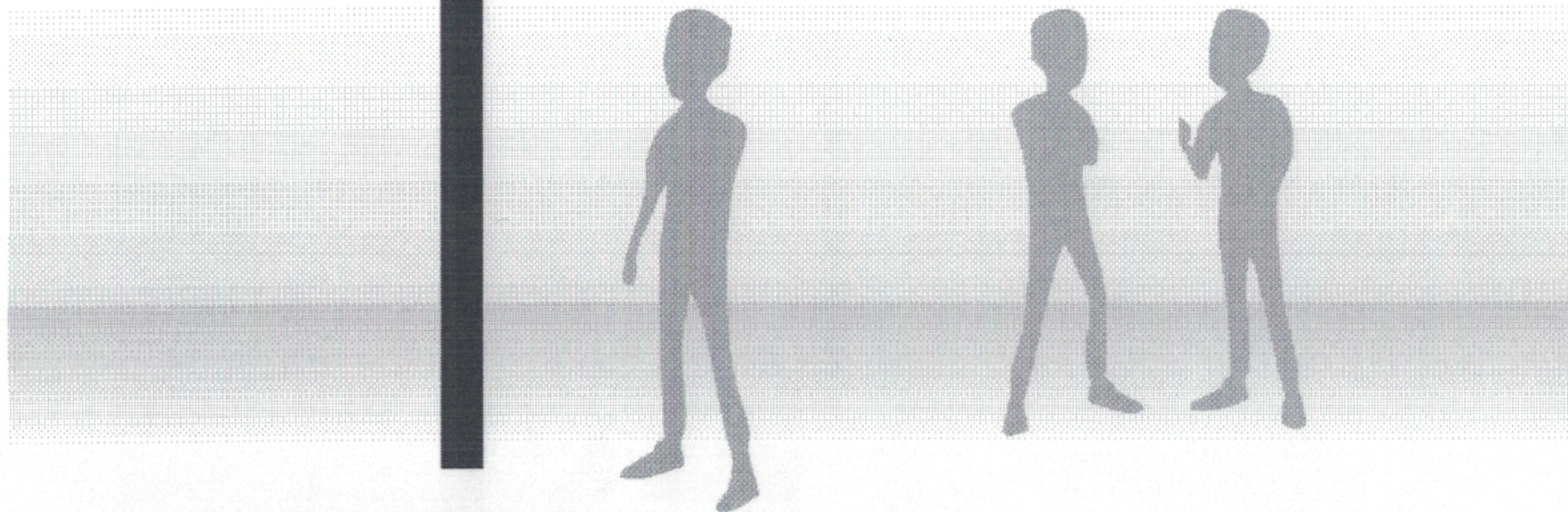

APPROVED BY:	DATE:
--------------	-------

Sample graphics, sizes & specifications given for proofing purposes. **Not For Production.**
This design is the property of **Consolidated Sign & Lighting Services Inc.**

Appendix “A”

THIS APPENDIX ‘A’ FORMS PART OF THE CONDITIONS OF YOUR PERMIT.

Changeable Message Sign (Location Sign)

A Changeable Message Sign is a sign that permits changing static messages; these signs would not be animated, nor would they include video.

a) Definition

A sign with the capability of content changes by means of mechanical or electronic input. This type of sign displays changing static messages for a fixed duration. It includes the following:

- Mechanical – a changeable sign whose display surface physically changes to reveal alternate messages, such as tri-vision or flip disc signs.
- Electronic – a changeable sign whose content can be changed by means of an electrically energized display matrix, such as an LED pixel board.
- A changeable message sign may be fully or partially incorporated as a component into any location sign. The messages shall be limited to advertise only the business, products or services located on the sign site.

b) Specifications

The following specifications must be applied to all changeable message signs;

- Minimum Dwell Time (MDT) – is the minimum amount of time, in seconds, which a static message must be displayed for.
- Maximum Transition Time (MTT) – is the maximum amount of time, in seconds, which shall be allowed between consecutively displayed static messages.

Type	MDT (sec)	MTT (sec)
Mechanical	20	2
Electronic	20	1

- The purpose of the MTT is to ensure a near instantaneous change between fully displayed messages. Transition effects such as wipe, slide, fade, or pixelate shall not be allowed.
- A changeable message sign that alternates solely between current time and current temperature shall be permitted a MDT equal to 15 seconds. The MTT shall be as listed in the previous table, dependant on whether the sign is mechanical or electronic in nature.
- All changeable messages signs must be designed to ensure that in the event of a malfunction the displayed image becomes fixed or blacks out.
- Changeable message signs may be illuminated per the specifications of this Policy. If the illumination (brightness) becomes a distraction to the highway, the display intensity shall be reduced to the satisfaction of MTO.
- Changeable message signs will be subject to all the other requirements of the Corridor Sign Policy that apply to freestanding signs.



Highway Corridor Management Payment Receipt

Ministry of Transportation

Receipt No:	R2024-0598103
Date paid:	May 13, 2024
Time paid:	9:08 PM
Payment method:	Credit Card
Card number:	*****4005
Cardholder name:	VERNON THOMSON
CCPay Session Id:	29285550
Authorization number:	05147J
Paid by:	Vernon Thomson
Phone number:	1-519-476-5029
Email:	VMTHOMSON@QUADRO.NET
Note	For payment inquiries to your card issuer, please refer to the Authorization Number above. For payment inquiries to the Ministry, please refer to the CCPay session ID above.

Statement #	Application #	Permit Number/Identifier	Fee	Amount Waived	Interest	HST	Total Amount
2024000616-0510	2024-00001304	SG-2024-31L-00000035	\$211.83	\$0.00	\$0.00	Exempt	\$211.83
Total Paid							\$211.83

PROJECT: NEW Pylon Sign with white double high output LED Cabinet, and NEW Watchfire Video Displays.



Proposed Pylon Sign

12 ft existing 6 in HSS Pole

Top Cabinet **99 x 36 in**
 Double Sided
 White Polycarbonate
 Translucent Vinyl Graphics

Video Displays **8 x 3 ft**
 W8mm LED RGB
 Full Colour 30 FPS
 Ignite OP Software

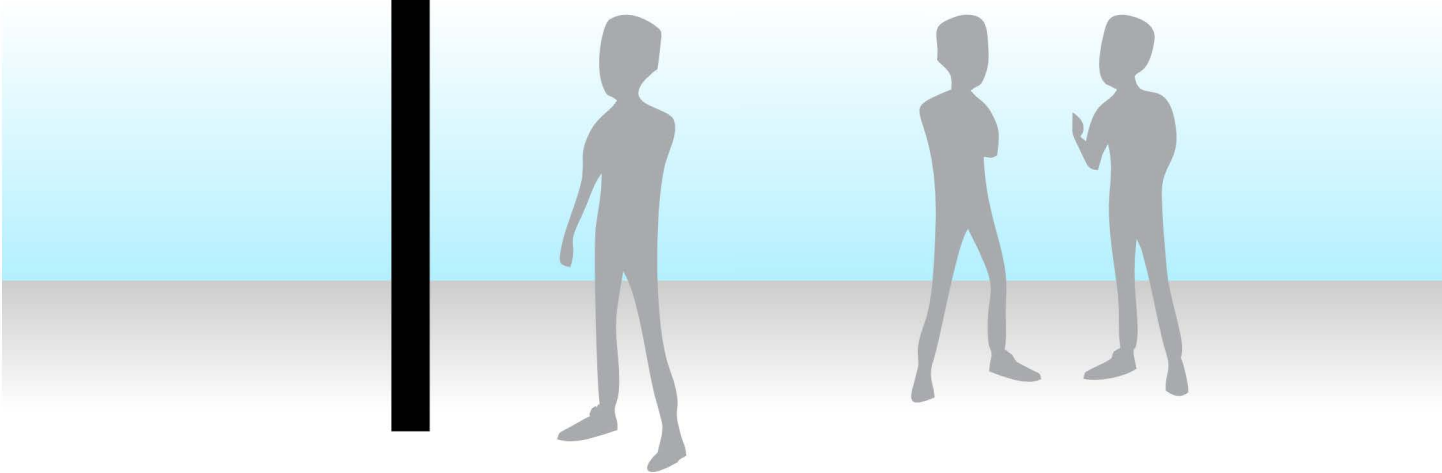

APPROVED BY:	DATE:

Sample graphics, sizes & specifications given for proofing purposes, **Not For Production.** This design is the property of **Consolidated Sign & Lighting Services Inc.** and is not to be copied without written permission of the owner.

From: Vernon Thomson [vmthomson@quadro.net]
Sent: November 26, 2023 9:27 AM
To: Melanie Thomson
Subject: Fwd: Watchfire Pylon Kirkton-Woodham Community Centre
Attachments: image002.png; ATT00729.htm; Kirkton Woodham-11222023165943.pdf; ATT00732.htm

Sent from my iPhone

Begin forwarded message:

From: Cam Eveland <ceveland@consolidatedsign.com>
Date: November 22, 2023 at 4:27:02 PM EST
To: Vern Thomson <vmthomson@quadro.net>
Subject: Re: Watchfire Pylon Kirkton-Woodham Community Centre

Sorry pricing didn't come till today.

A new top box with LED internal lighting, approved graphics installed as per drawing would be \$8975.00 + HSTcomplete.

The new LED message center I have attached a separate quote with the specs of the unit. \$46409.23 +HST

Installation of EMC would be \$1875.00

Main leectrical connection would be required on your end by licensed electrician.

On 2023-11-21 12:52 p.m., Vern Thomson wrote:

Hi Cam – Sorry for the email confusion. Thanks for the info on the sign.

However the pricing info seems to be missing in the forwarding of emails.

Thanks
Vern Thomson

----- Forwarded Message -----

Subject: Watchfire Pylon Kirkton-Woodham Community Centre
Date: Thu, 26 Oct 2023 10:50:45 -0400
From: Graphics <graphics@consolidatedsign.com>
To: Cam Eveland <ceveland@consolidatedsign.com>

Drawing attached.

On Premise Quote



QUOTE NUMBER: 2321215.0 (Version 0) DATE: 11/22/2023

SIGN ID: 1841040 W8-S

Consolidated Sign & Lighting Services Inc 9011839
Cameron Eveland, Sales
90 Victoria Ave E
Crediton, ON N0M 1M0
519-234-6721
ceveland@consolidatedsign.com

Shipping Destination
Consolidated Sign & Lighting Services
Inc
90 Victoria Ave E
Crediton, ON N0M 1M0

Job Site
Name: Kirkton - Woodham Community
Center
Address:
City:
State: Zip:

PRODUCT SPECIFICATIONS

Pixel Pitch: W8mm LED RGB
Pixel Matrix: 108 X 288
Ventilation Style: Front Ventilation
Cabinet Size: 41in H x 8ft 3in L x 5in D
Viewing Area: 36in H x 8ft L
Cabinet Style: Double Face (Slim)
Character Size: 11 lines / 57.6 Characters at a 3" type
Approx. Weight: 652.00 Lbs.
Warranty: Standard 5 Year Watchfire warranty applies.
Mfg. Lead Time: 3-5 weeks (Based on signed quote, receipt of deposit, and **artwork approval - if applicable**)

Electrical Service: 120 VOLT 34.0 amps (17.00 per face) Single Phase Service. Refer to the Installation manual for details on wiring. Based on 18 hours of operation a day, plus or minus 10% depending on how the sign is programmed.
Example: 21.2 KWHrs a day x \$0.12 = \$2.54/Day

OPTIONS

Software
Software Training
Communications

Wireless Data Plan
Cabinet Separation
Power Requirements
Temperature Sensor
Sign Mounting Kit
Technician On-Site
Warranty

Ignite OPx (cloud-based)
Web Based Software Training
OPx - 4G Wireless w/ Watchfire Cellular Data Plan for Canada
Life-of-sign Data Plan for Canada
Standard Up To 15 Feet
CUL for Canada, 120Volts
w/100-Step Photocell w/15 ft Cable
Not Ordered / Not Required
Not Ordered
Standard 5-Year Parts Warranty

STANDARD FEATURES

Brightness Daytime 7500 NITs Maximum;Nighttime 700 NITs Maximum
Color LED RGB
Color Capability Min. 1.2 Quintillion
Includes Ignite Graphics Software
Video up to 30 FPS
Viewing Angles 150 Horizontal/95 Vertical

ORDER ACCEPTANCE QUOTE VALID UNTIL 1/6/2024

System Price: 8mm Highbrightness Color LED Message Center - Front Ventilation

LED Display only
\$46409.23 +HST

\$22,681.00 USD

To order Sign ID 1841040, sign here and return with down payment

Signature: _____ Date: _____

Buyer acknowledges that prior to executing this Agreement Buyer has read or has had the opportunity and means to review the TERMS OF SALE and Seller's LIMITED WARRANTY, SOFTWARE LICENSE, AND LIMITATION OF LIABILITIES AND REMEDIES at <http://watchfiresigns.com/terms-and-conditions-of-sale> or in the alternative, a hard copy has been provided to Buyer and its receipt is acknowledged.
This quote/offer is expressly limited to the acceptance by the buyer of its exact terms, including the terms of sale and seller's limited warranty, software license, and limitation of liabilities and remedies, all of which are a part of the agreement. Any purchase order or related documents buyer issues to seller (even if it contains terms in addition to or inconsistent with the terms of this agreement) for this transaction shall constitute buyer's unconditional agreement to be bound exclusively by the seller's terms and conditions of this agreement, and buyer hereby agrees that such additional or inconsistent terms shall not apply nor become a part of this agreement.